

# Installation Instructions

## Touchbar Panic Exit Device EN 1125

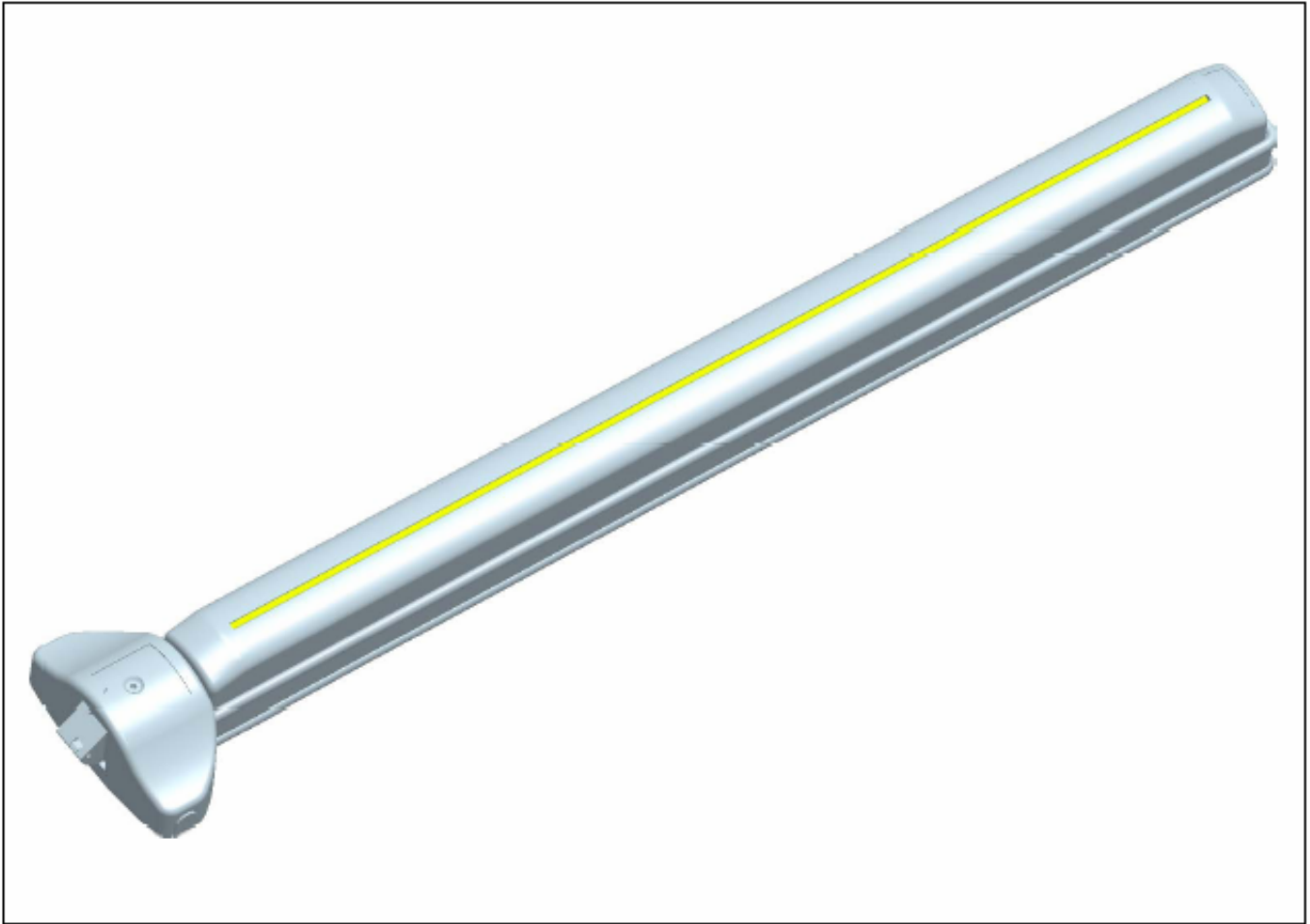

### IMPORTANT INFORMATION

#### PLEASE READ THESE INSTRUCTIONS CAREFULLY

Door – Maximum specification of door on which this product should be fitted.

- Maximum weight of door = 200kg
- Maximum width of door = 1300mm (1200mm Touchbar) – 1100mm (760mm Touchbar)

This product is designed for peoples safety and complies with EN 1125. **Do not** modify the product in anyway other than those outlined in these instructions.

This product is non handed and can be fitted on both left handed and right handed doors.

For internal use only.

	Eurospec Architectural Hardware Stancliffe Street, Mill Hill Blackburn BB2 2QR
	1121 – AA 0033      06
EN1125: 1997+A1:2001	3 7 6 1 1 3 2 2 B

Upon unpacking your product you will find the following parts.

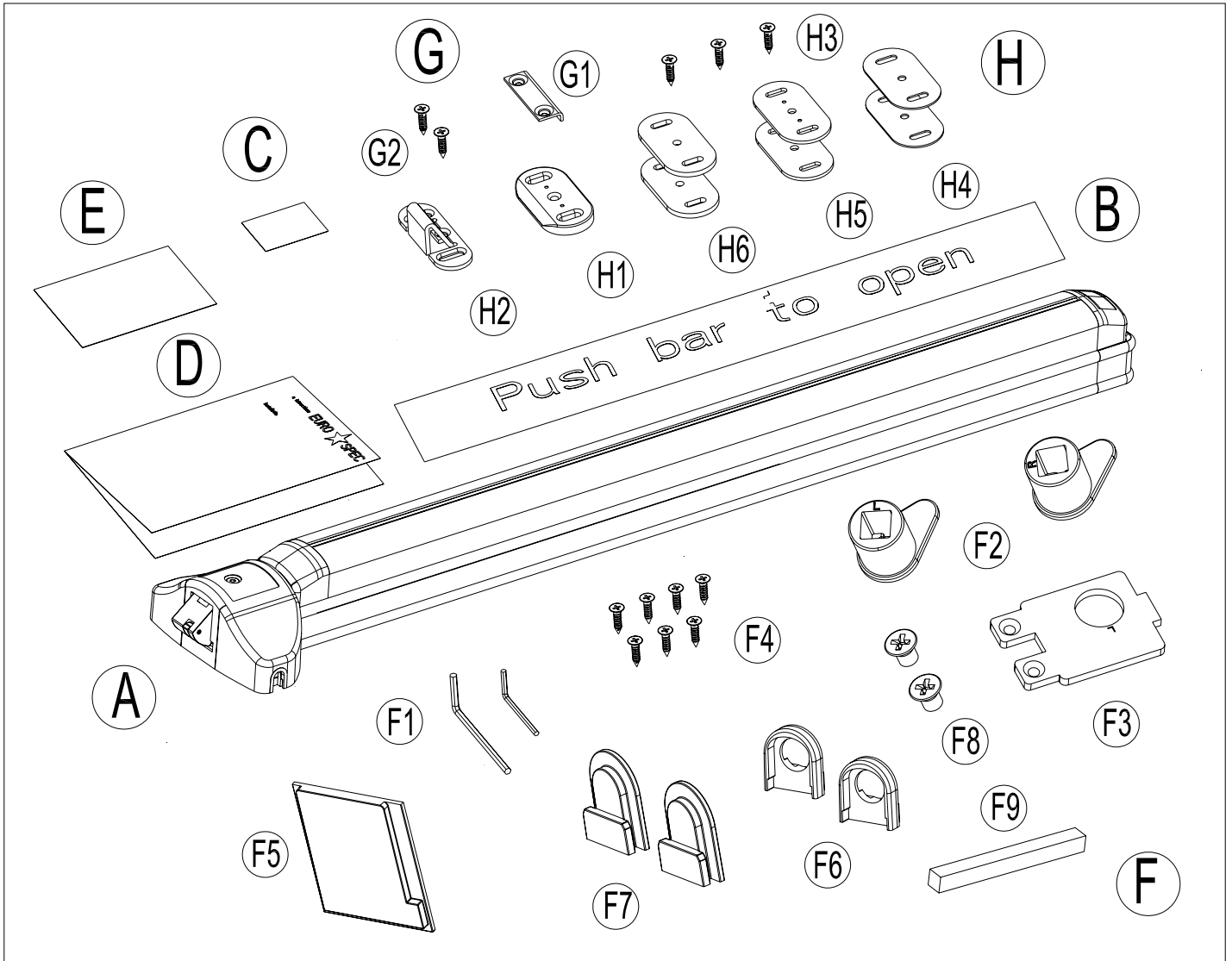

## PARTS LIST

- |   |                       |
|---|-----------------------|
| (A) Touchbar X 1                              | (G) Rebate Kit        |
| (B) Push Bar to Open sign X 1                 | (G1) Rebate Plate X 1 |
| (C) Screw Cover Label X 1                     | (G2) Screws X 2       |
| (D) Fitting Instructions X 1                  | (H) Striker Kit       |
| (E) Reversible Template X 1                   | (H1) Striker No 1 X 1 |
| (F) Standard Fitting Kit                      | (H2) Striker No 2 X 1 |
| (F1) Allen Keys X 2                           | (H3) Screws X 3       |
| (F2) Right and Left Followers X 2             | (H4) 1mm Packers X 2  |
| (F3) Reversible Follower Supporting Plate X 1 | (H5) 2mm Packers X 2  |
| (F4) Screws X 7                               | (H6) 3mm Packers X 2  |
| (F5) Latch Cover X 1                          |                       |
| (F6) Rod Guides X 2                           |                       |
| (F7) Blanking Covers X 2                      |                       |
| (F8) Supporting Plate Fixing Screws X 2       |                       |
| (F9) 8mm Spindle X 1                          |                       |

For single or multi-point locking see diagrams below.

Additional locking devices may be required. Refer to relevant product instructions.

**Door Suitability**

This Touchbar and any Locking Devices can be fitted on most wood, steel or aluminium Doors

**Door size limitations**

Maximum clear opening height = 2450mm.

Minimum clear opening width = 400mm per door.

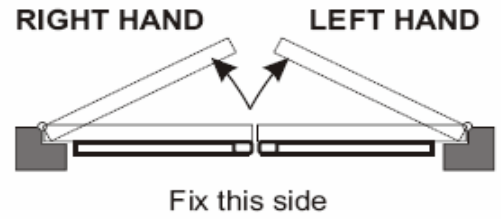

**Single Door**

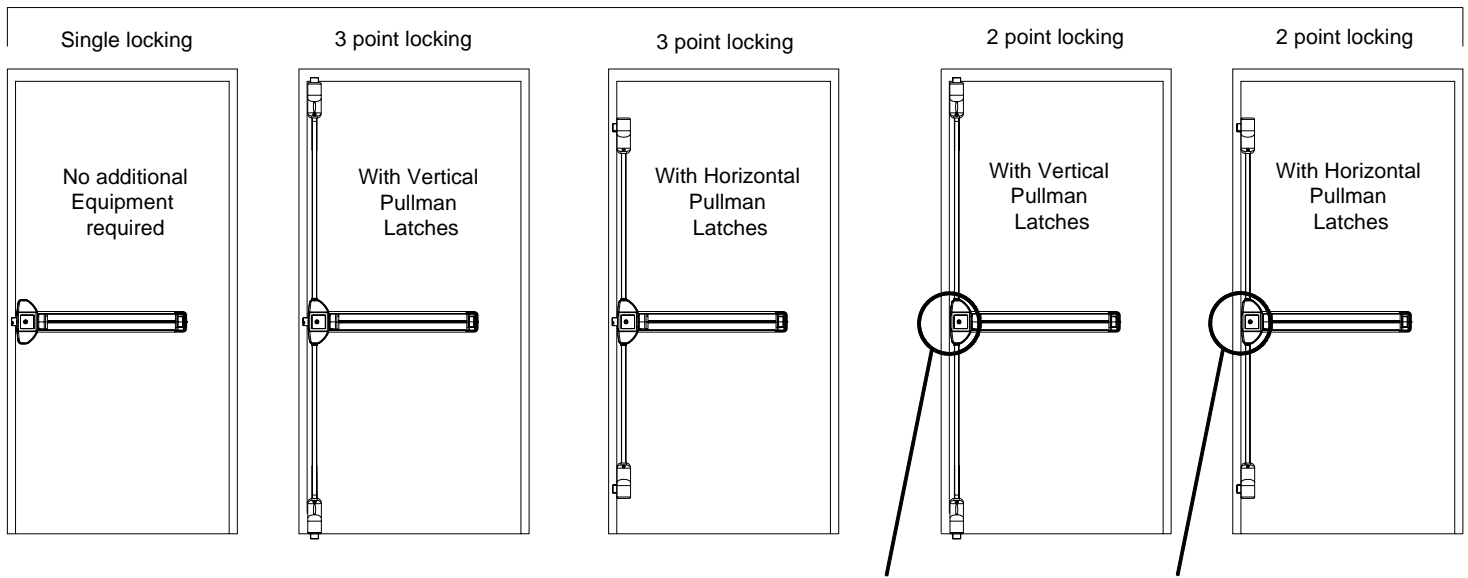

**If two-point locking option is required, disable the Touchbar latchbolt by fitting the latch cover (Item F5) into the main casing.**

**Rebated Double Door**

**Non Rebated Double Door**

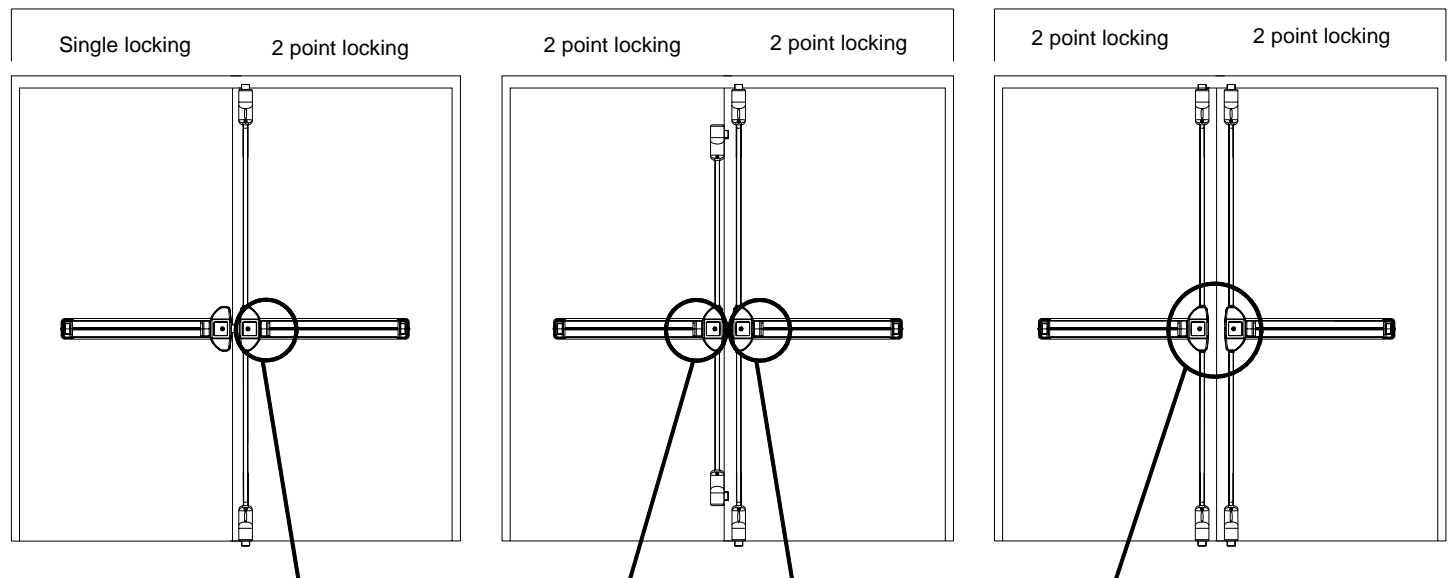

Disable the Touchbar latchbolt by fitting the latch cover (Item F5) into the main casing.

- 1) Check that the door and frame are in good condition and that the door operates correctly. Measure door opening width, if this is less than 790mm (31" ) the Touchbar will require cutting down. Follow the instructions in section 5.
- 2) Referring to **Fig 3.1**. With the door closed, draw a horizontal line 1000mm ± 100mm from the finished floor level.
- 3) Correctly position the template depending upon door/recess type and handing of door, Refer to **Figs 3.2 – 3.5** below and drill four holes using a suitable sized pilot drill for the supplied screws.

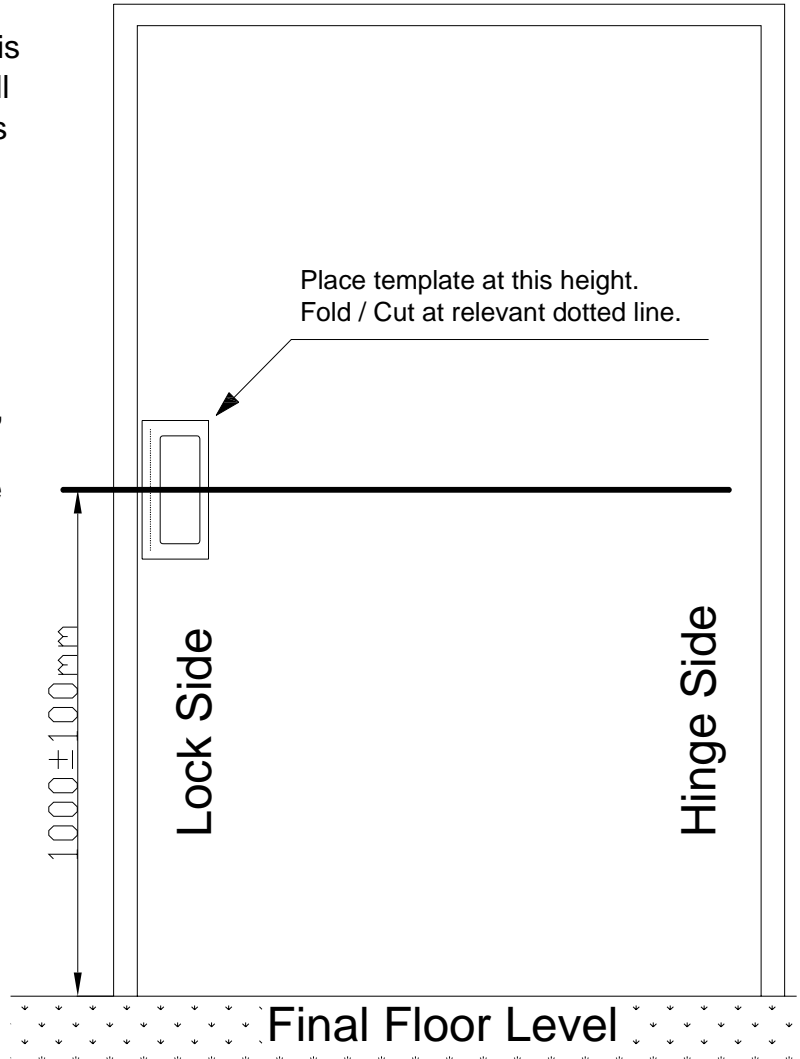
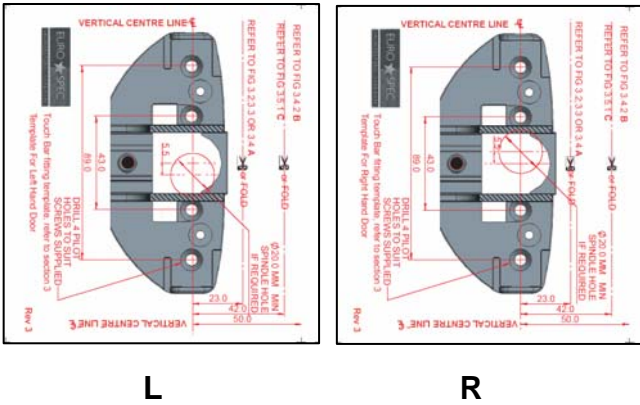

Common types of rebate

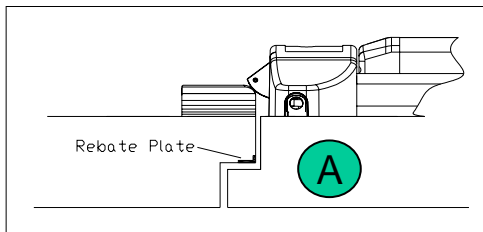

Fig 3.2

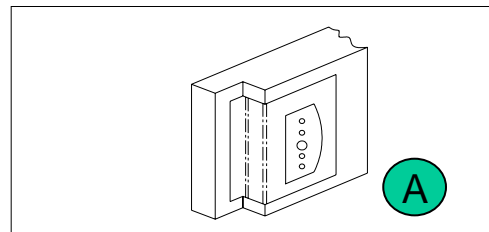

Fig 3.2.1

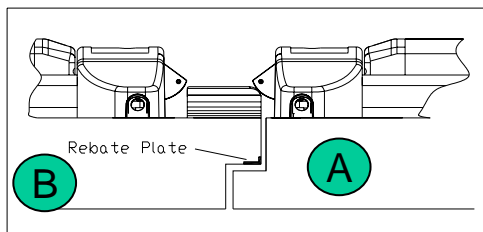

Fig 3.3

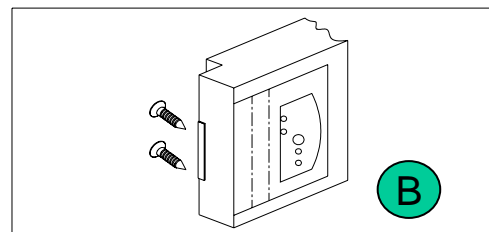

Fig 3.4.2

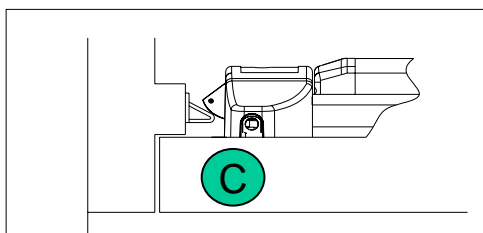

Fig 3.5

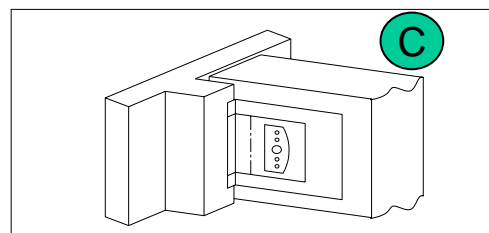

Fig 3.5.1



**Note: If fitting External Locking Attachment, please follow steps 1&2. If External Locking attachment is not required, please proceed to step 3.**

- 1) Select the correct hand Follower (item F2) and Follower Support Plate (item F3) and fit to the Touchbar assembly using screws ( item F9). (See Fig 4.1)
- 2) Using the correct hand of template, drill the 20mm diameter spindle hole through the door. At this stage, External Locking Attachment needs to be fitted using its relevant installation instructions.
- 3) If fitting additional locking devices, i.e. Pullmans, now is the time to fit the actuating rod ends into the Touchbar. (See Fig 4.2) and also refer to relevant Pullman instructions).
- 4) Position template according to section 3 preparation. Remove front and back covers from Touchbar. Secure to door using relevant fixing screws. (See Fig. 4.3)
- 5) Check that the Touchbar is mounted horizontal and that the push bar actuates the latch mechanism correctly. If fitted, also check that the Follower rotates correctly.
- 6) Refit front cover ensuring relevant blank or rod guides are fitted. (See Fig 4.4). Refit rear cover.
- 7) Check for correct operation.
- 8) Finish with fitting cover label to mask screw fixing.

4

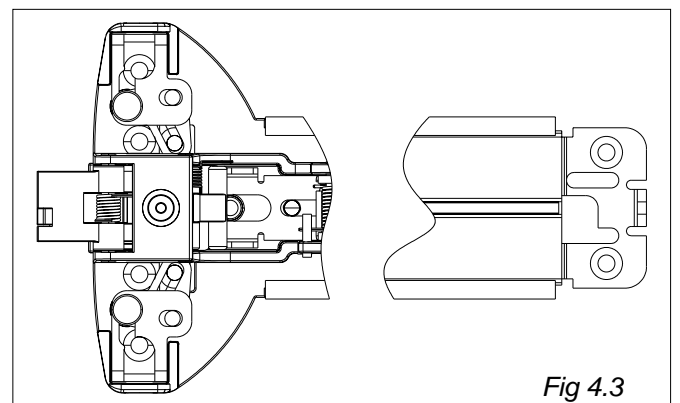
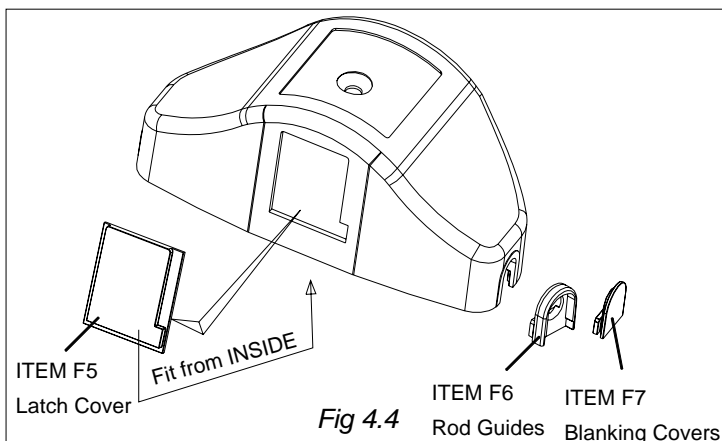
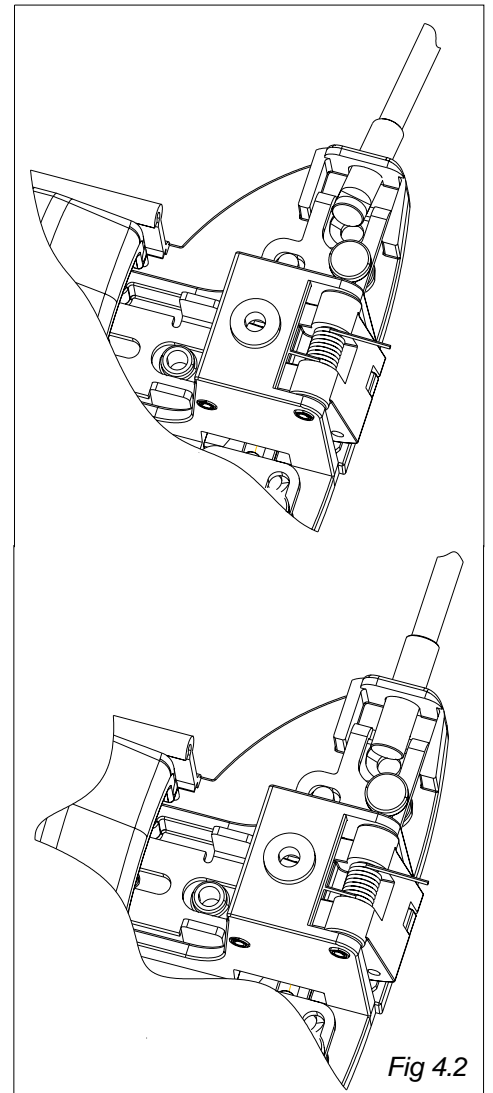
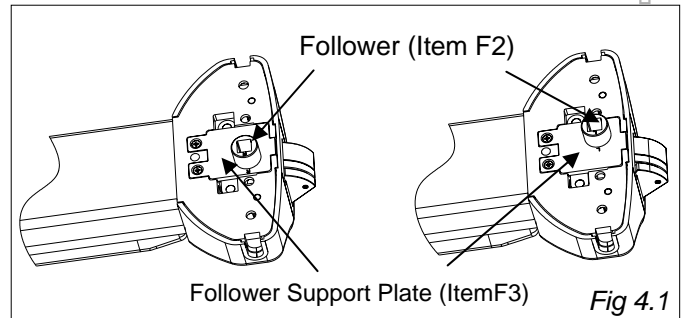

**Installing the Striker.**

- 1) Referring to **Figs 3.2 – 3.5**. With the door closed, position the Striker. Use packers as necessary to obtain a close fit between Latch and Striker. The door should not rattle nor need to be pushed to lock the latch.
- 2) Secure the Striker in position using 2 screws supplied. (Item H3).
- 3) Once satisfied with the correct operation, fit the middle screw.
- 4) Ensure that the Striker is fully secure.
- 5) If fitting to a rebate door fit the optional Rebate Plate ( Pack G) as shown in **Figure 4.6**.

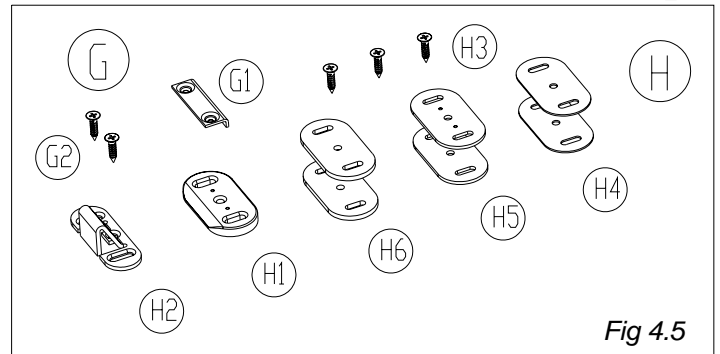

Fig 4.5

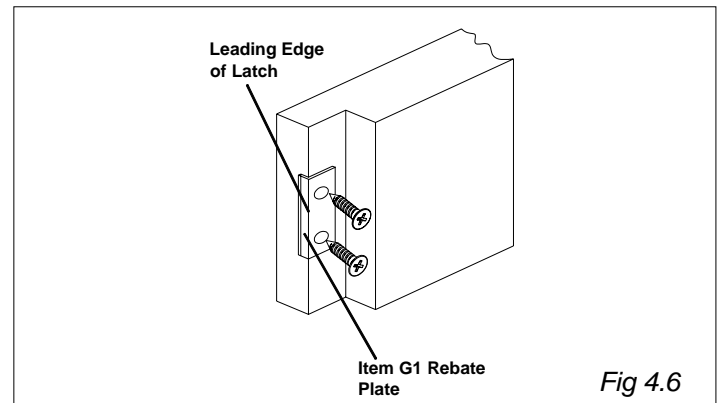

Fig 4.6

Modifying length of Touchbar – if required

- 1) Using the supplied Allen key, remove screw and depress Touchbar to release front cover. (See Fig 5.1)
- 2) Using a #0 Pozi head driver, remove the two screws from the end of cap at the latch end. (See Fig 5.2)

**Note:** Using the incorrect driver may result in damage to the screw head.

- 3) Remove cover from opposite end using Allen key. (See Fig 5.3)

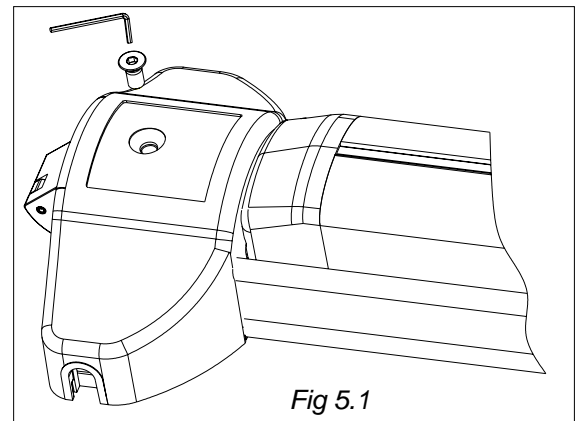

Fig 5.1

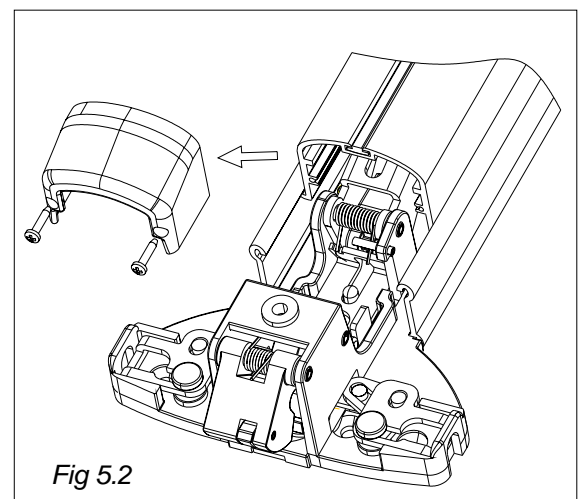

Fig 5.2

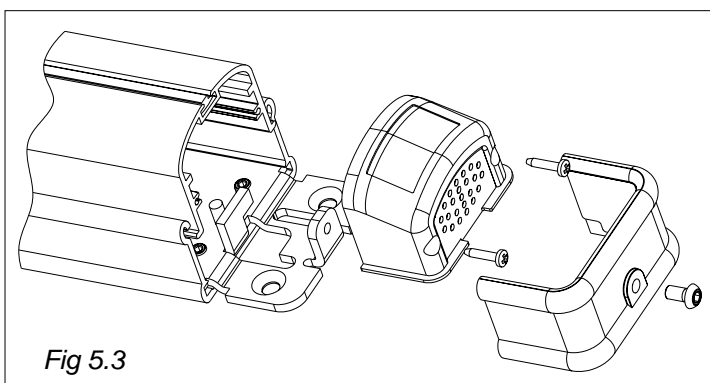

Fig 5.3

## Modifying length of Touchbar (continued)

- 4) Slide out Touchbar. (See Fig 5.4)
- 5) Release the four grub screws and slide out rear fixing plate. (See Fig 5.5)
- 6) Using Figs 3.2 – 3.5.1 as a guide to fitment, refer to the template and obtain the centre line distance, ie. 23mm, 42mm or 50mm. Also using Fig 5.6 as reference, determine the overall length of the Touchbar.

The standard Touchbar is 760mm long. Use the following formulae to determine cut length:

**Note:** Distance from the Follower centre to the front of the Touchbar is 20mm. (760mm – 20mm = 740mm).

**Waste = X – Gap – Template – 740mm**

### Example 1

X measured at 745mm

Waste = 745 - 15 - 42 - 740mm = -52mm

You will need to cut the extrusion down by 52mm.

### Example 2

X measured at 825mm

Waste = 825 - 15 - 23 - 740mm = +47mm

You **DO NOT** need to cut the Touchbar down.

- 7) Measure distance and cut to the required length. Take care not to crush the extrusions when clamping. Ensure cut is at right – angle to base. (See Fig 5.7)

**Note** Remove the same amount from both Touchbar and casing.

- 8) If the required length is less than 650mm, the Driver Bar also needs cutting. Remove the Rear Follower Assembly (four grub screws plus Drive Bar clamp screw). Release clamp screw at opposite end. Remove Drive Bar. (See Fig 5.8)
- 9) Measure distance and cut components to the required length. (See Fig 5.9)

- 10) Deburr as necessary.

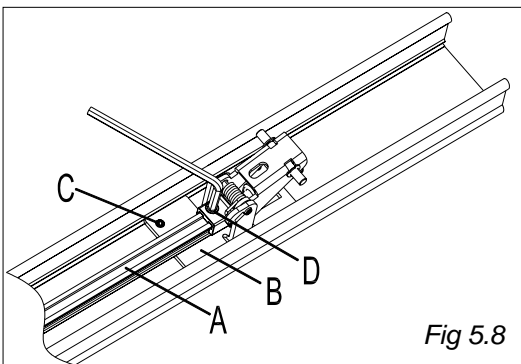

Fig 5.8

- A** Driver Bar
- B** Rear Follower assembly
- C** Rear Follower Assembly Grub Screws
- D** Drive Bar Clamp Screw

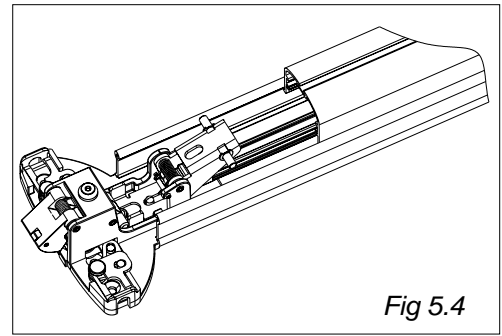

Fig 5.4

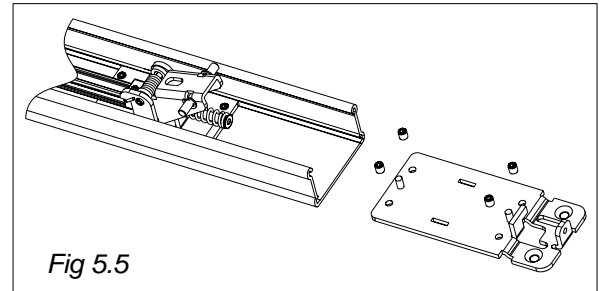

Fig 5.5

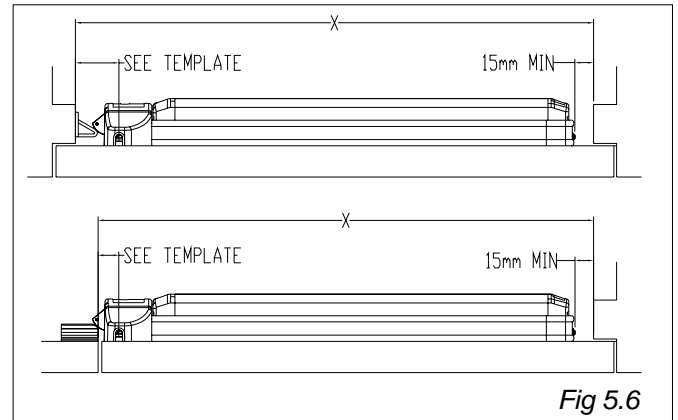

Fig 5.6

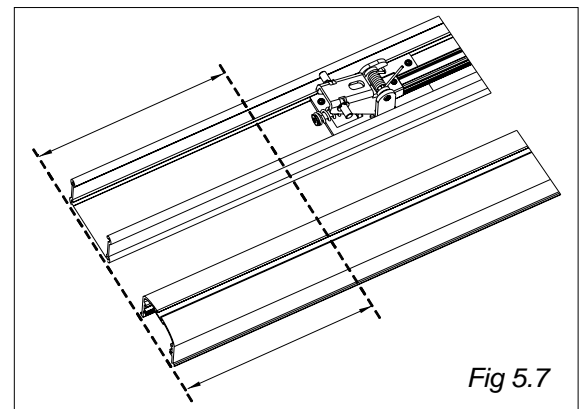

Fig 5.7

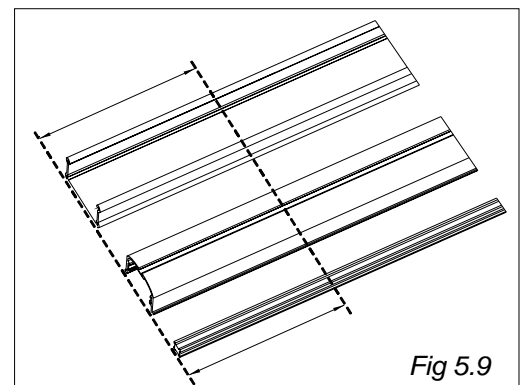

Fig 5.9

## Modifying length of Touchbar (continued)

5

11) Re-assemble Touchbar as follows:

- a) Refit Drive Bar into front clamp and secure with grub screw.
- b) Slide Rear Follower assembly into the base extrusion until the Drive Bar fits into the rear clamp. Secure with grub screw (**See Fig. 5.8**).
- c) Tighten the four grub screws in the Rear Follower Assembly. **DO NOT OVER TIGHTEN!**

d) Refit rear fixing plate, again **DO NOT OVER TIGHTEN** the grub screws. (**See Fig 5.5**)

e) Slide Touchbar over the Rear, then Front Follower pins. Ensure the pins locate in the correct slots on the Touchbar. (**See Fig 5.10**)

f) Refit the front end cap with #0 Pozi head driver. (**See Fig 5.2**)

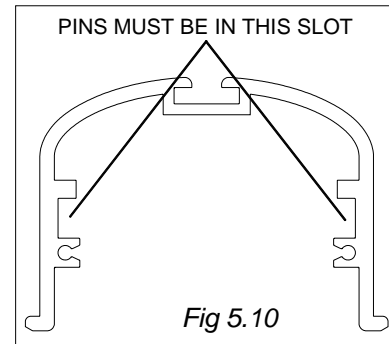

- g) **DO NOT** fit the front or rear covers at this stage. The unit is now ready for installation. See Section 4.
- h) Check that the Touchbar operates freely along its length and that the latch retracts and springs out freely and that the Touchbar returns to its rest position.

## Final Checks

Once the Installation is complete, check that the Touchbar operates correctly. To test this, apply pressure to the doors and try to release it using the Touchbar. Repeat this for the front, middle and end positions. Apply the 'Push bar to open' label (item B) and the screw cover label (item C) in their relevant positions.

## Operational instructions + Maintenance

This Touchbar is fitted to comply with EN1125. No instruction of operation is required. For the end user the Touchbar should be easily operated by hand or body pressure in a panic situation. Ensure that the Strikers are secure, clean and free from any obstruction.

PLEASE LEAVE THESE INSTRUCTIONS WITH THE END USER



Stancliffe Street  
Mill Hill  
Blackburn  
BB2 2QR  
Tel: +44 (0) 1254 274100  
Fax: +44 (0) 1254 274111  
Web: [www.eurospec.co.uk](http://www.eurospec.co.uk)